

## Opening and Closing a Jump Ring

**Step 1.** Hold Jump ring with 2 pairs of pliers.

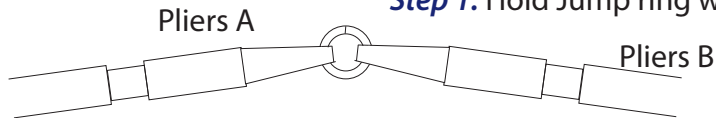

**Step 2.** Gently push the Jump ring apart, moving Pliers A away from you and the Pliers B towards you.

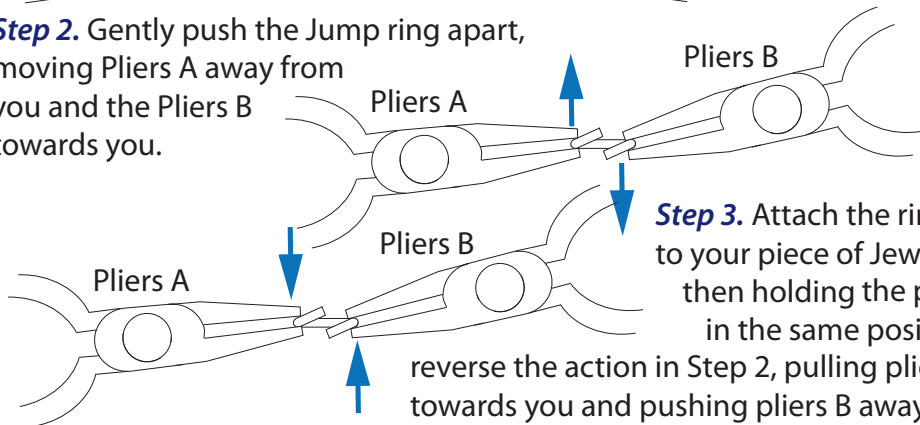

**Step 3.** Attach the ring to your piece of Jewellery, then holding the pliers in the same position, reverse the action in Step 2, pulling pliers A towards you and pushing pliers B away.

**Quick tip:** When closing your Jump ring, push the ends just past each other and then pull them back in line to ensure a tight, neat closure.