

Belera  
Leatherette Pushchair & Infant Carrier  
BP8088(WA16H)

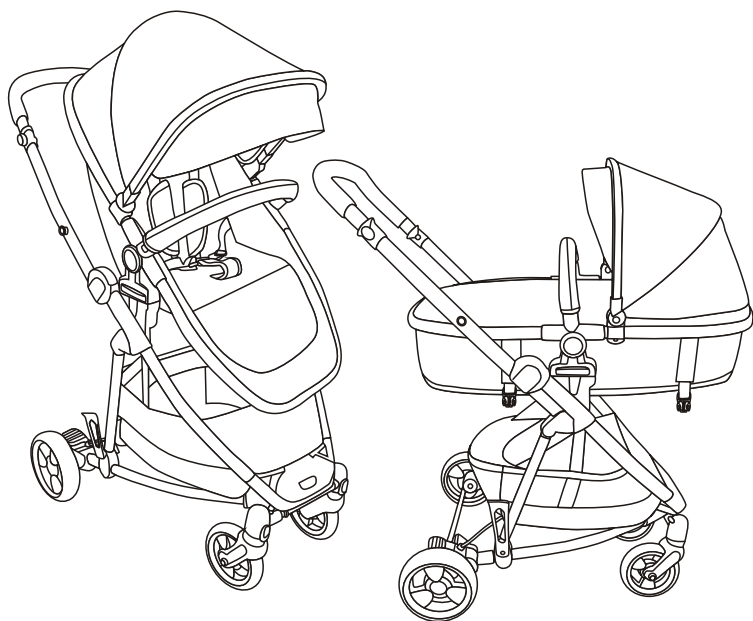

INSTRUCTION MANUAL

## **Important: Keep these instructions for future reference.**

**WARNING:** Don't carry additional children, bags, goods or accessories in the stroller except those recommended by the manufacture.

**WARNING:** To avoid injury ensure that your child is kept away when unfolding and folding this product.

**WARNING:** Never leave your child unattended.

**WARNING:** Do not let your child to play with this product.

**WARNING:** Before making adjustments to the stroller, ensure that the child's body is clear of any moving parts.

**WARNING:** Always use the restraint system.

**WARNING:** Child may slip into leg openings and strangle. Never use in reclined carriage positions.

**WARNING:** Do not allow the child to stand up on the seat.

**WARNING:** This stroller is designed for one child only.

**WARNING:** Do not hang bags on the handle, as this will affect the stroller's stability.

**WARNING:** Do not use on escalators or stairs. Fold the stroller and carry it by hands.

**WARNING:** Check that the pram body or seat unit or car seat attachment devices are correctly engaged before use.

**WARNING:** This product is not suitable for running or skating.

**WARNING:** Always activate the brakes when stop the stroller, put or take off any accessories.

**WARNING:** Ensure that all the locking devices are engaged before use.

**WARNING:** Any goods carried in the basket should not exceed 3 kg;

**WARNING:** Do not overload as the stroller may become unstable. Maximum weight must not exceed 15kg in the seat unit.

**WARNING:** Do not add additional mattress thicker than 5mm.

**WARNING:** Bassinet mode, suitable from birth until child can sit unaided. Max weight of the child: 9kg.

**WARNING:** Seat unit mode: This seat unit is not suitable for children under 6 months, Max weight of the child: 15kg.

**WARNING:** Use a harness as soon as your child sit unaided. .

**WARNING:** Do not use the stroller near open fire, exposed flame, barbecue or heater.

**WARNING:** Do not use the stroller if any screws, nuts, bolts, etc. are missing or any component is damaged.

**WARNING:** This seat unit is not suitable for children under 6 months (used as seat unit).

**WARNING:** Do not lift the stroller by the bumper bar it may disengage.

**This product complies with EN 1888:2012.**

## **Important: Keep these instructions for future reference.**

**WARNING:**Note that the fabric patterns and stroller accessories in this instruction may vary from the one you have purchased.

**WARNING:**Only replacement parts supplied or recommended by the manufacturer/ distributor shall be used.

**WARNING:**Always apply the brakes when the pushchair is stationary, and when placing and removing children.

**WARNING:**Please be sure to use a mattress when the product is suitable for the use of a newborn baby.

## **Care and maintenance:**

1. Wipe with a damp cloth gently.  
Do not iron. Do not bleach.
2. Periodically check for loose and broken parts.
3. Exposing the stroller to direct sunlight for long periods may cause fading.
4. If the stroller becomes wet, dry the metal parts and store it at cool and ventilate.  
Please ensure the leatherette is dried immediately.
5. The leatherette may become yellowish over a period of time due to exposure in the air. The warranty does not cover discolouration of the leatherette.

**This product complies with EN 1888:2012.**

## Schematic diagram of frame parts

1. Handle grip
2. Safety latch release button
3. Main connector
4. Folding hook
5. Front leg tube
6. Footrest
7. Directional lock
8. Front wheel socket
9. Front wheel
10. Rear leg tube
11. Brake line
12. Rear wheel
13. Wheel cap
14. Supporting tube
15. crossbars
16. Brake unlock pedal (green)
17. Break pedal (red)
18. Handle tube L
19. Folding lever

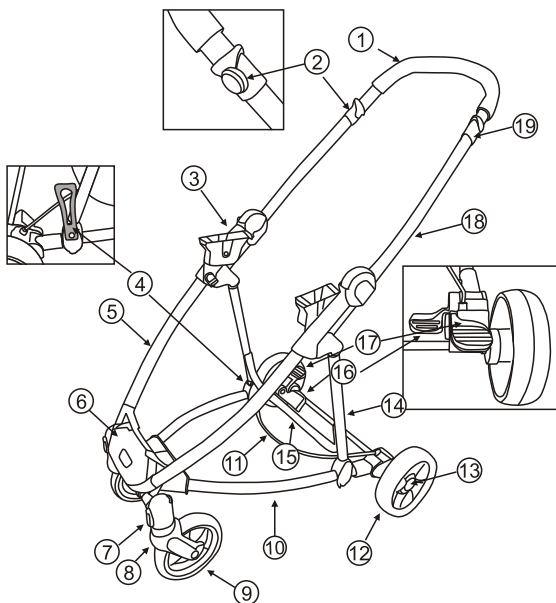

## Schematic diagram of seat unit parts

20. Seat unit upper
21. Canopy holder
22. Connectors of seat unit
23. Safety bar button
24. seat unit adjustment button
25. Seat unit release catch
26. Seat unit base
27. Seat unit bottom
28. Safety front bar
29. Jump ring
30. Canopy frame
31. Seat unit supporting lever

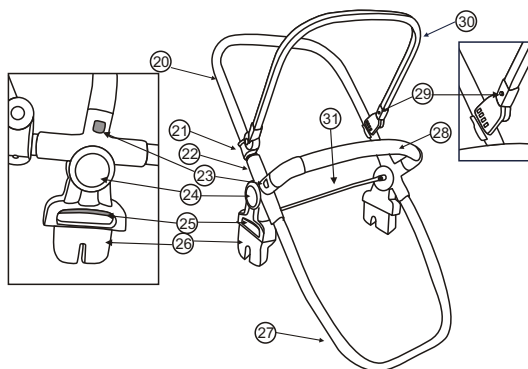

## To open the stroller

Release the folding hook as the picture shows. Then open the folded stroller, lift up the handle until the whole stroller open completed.

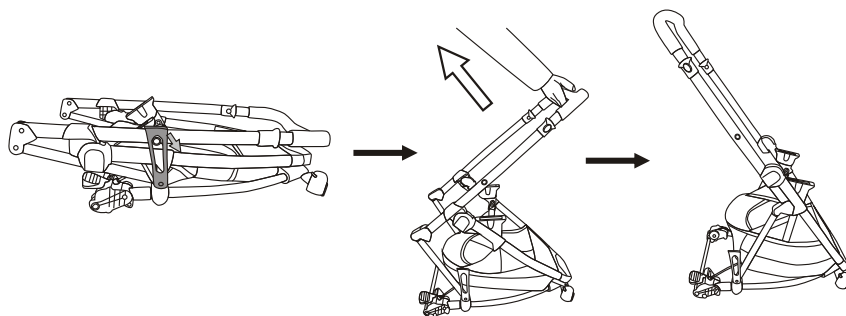

## Front wheel assembly

Insert the front wheel into the front leg until you hear a click sound. Repeat this process for both swivel wheels.

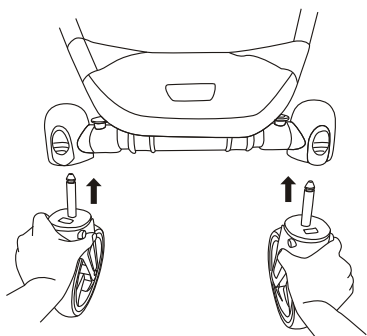

To lock the front swivel wheel, align wheels to rear of front leg and push the lock down on each front leg (A). To unlock push the lock up (B).

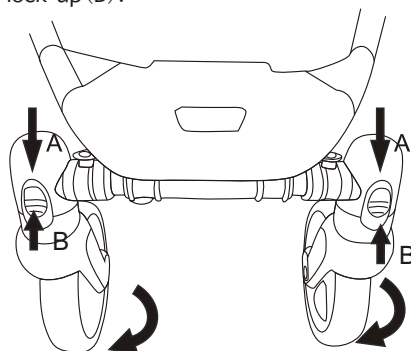

## ***Remove the front wheels***

To remove, push tab(A) and pull the wheel off.

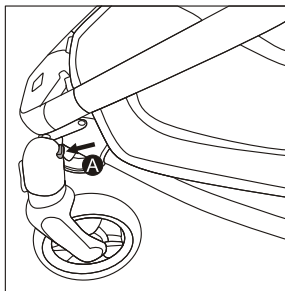

## ***Rear wheel assembly***

Adjust the direction of the rear axle, make sure you have correctly lined up the flat edge on the axle with the flat edge of the hole. Then push the rear axle into the whole, until you hear a click sound. Ensure that it is engaged before use.

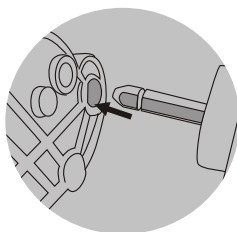
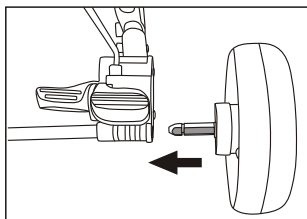

## Remove the rear wheels

Show as the picture, push forward the button while you taking out the rear wheel to release the rear wheel.s

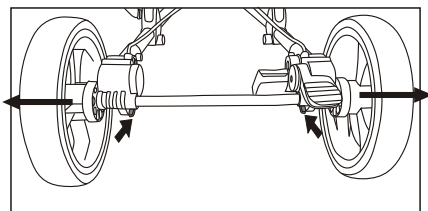
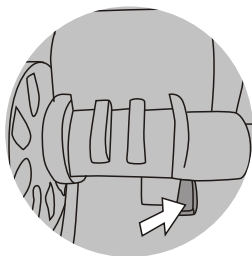

## To use brakes

To engage the brakes, press down the red brake pedal (A).

To disengage the brakes, press down the green release pedal (B).

**Note:** If you hear a rubbing or a clicking noise from one of the rear wheels, then lift brake pedal (A) lightly with your foot, if the noise continues then you may need to tighten the adjustment nut (C) on the brake cable using two 8mm spanners. Once you have tightened nut (C) ensure the locking nut (D) is tightened up against it.

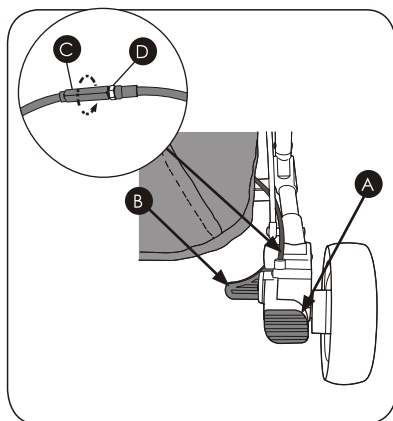

## Canopy attachment

Fix the attachment brackets of the canopy to the metal construction (Point A).

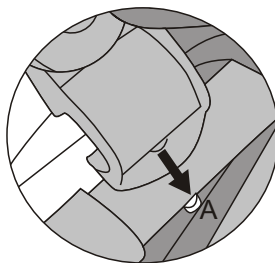
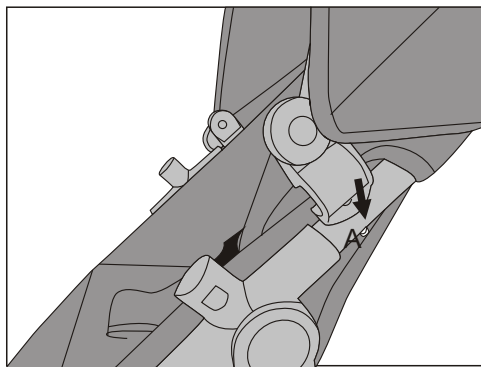

**WARNING:** must install the canopy before using the stroller.

## Canopy release

Pull the brackets of the canopy off the metal construction to realize the release.

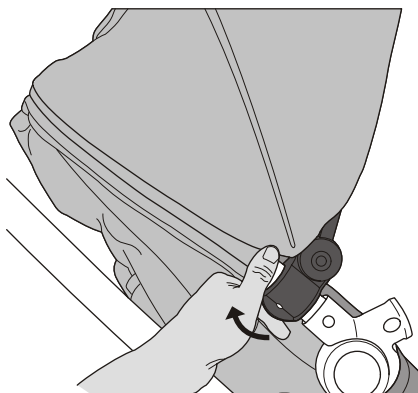

## Canopy attachment and release(In order to wash)

1.Unzip (or fasten) the zip which is to connect the canopy and the seat unit.

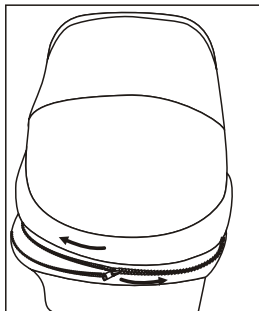

2.Press the jump ring located inside of canopy frame, pull out (insert) canopy frame, to release (install) canopy.

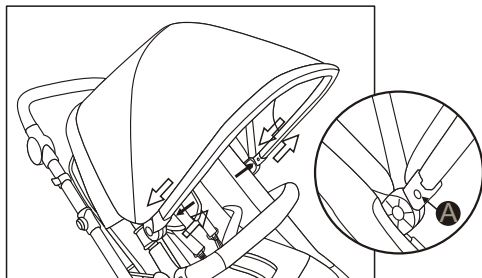

3.Pull out (insert) the PP pipe which is fixed in the canopy frame, to release or install canopy cover.

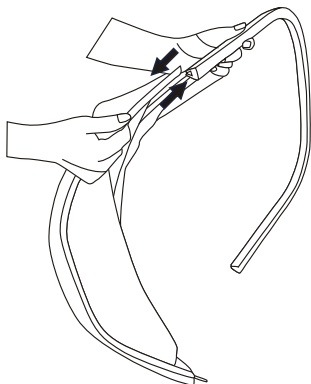

4.Canopy with frame

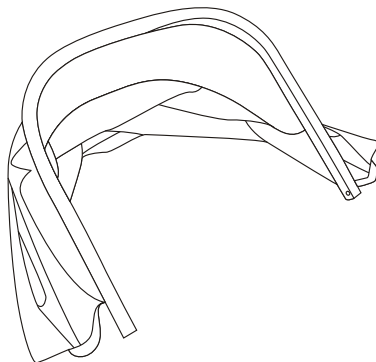

## To install the seat unit

**WARNING:** This stroller is suitable for child from 6 months to 15kg used as seat unit and suitable for child from birth to 9kg used as carrycot. Please use the safety belts when the child can sit unaided.

Match the connector (A) of both sides of the seat unit in to the basement (B) on the stroller until you hear a click sound to make sure it is installed correctly.

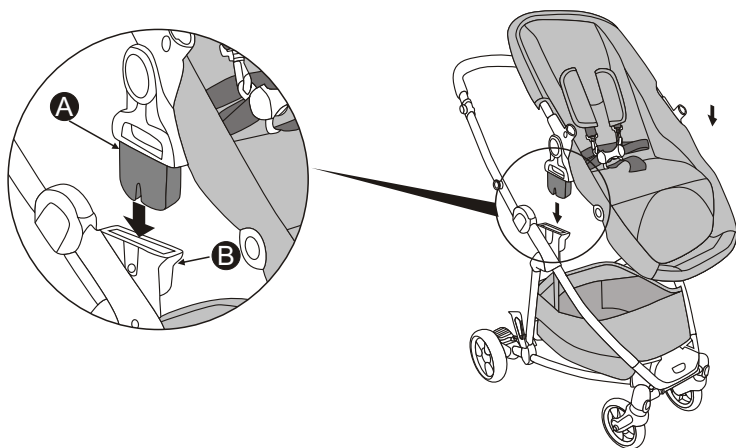

## To install the seat unit (continue)

**IMPORTANT:** When use it as a carrycot, please install it facing to parents (A). You can install it facing to parents (C) or forward (B) when you use it as a seat unit.

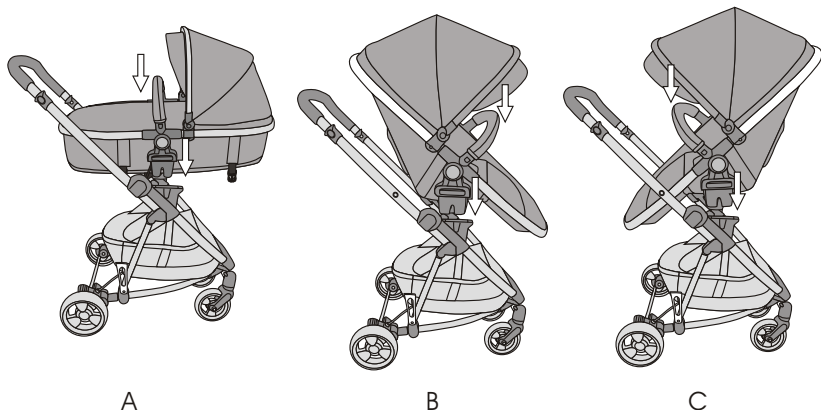

A

B

C

## Seat unit adjustment

Push the adjustment button on both side of seat unit, to adjust the sitting angles.

**Note:** Only make it level condition when use it as a carrycot.

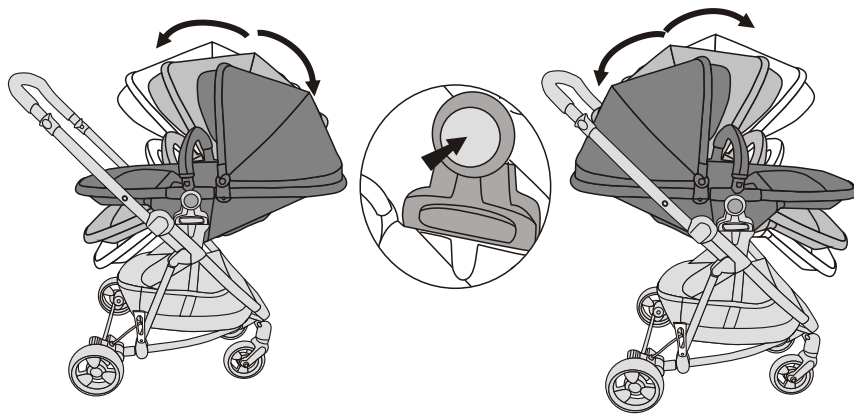

## Release Seat unit

Press in the release catches on each side of the seat unit, and lift the seat unit off the chassis.

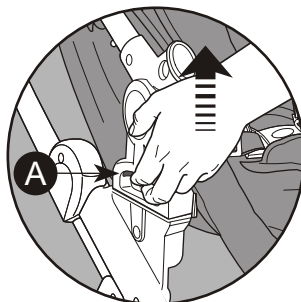
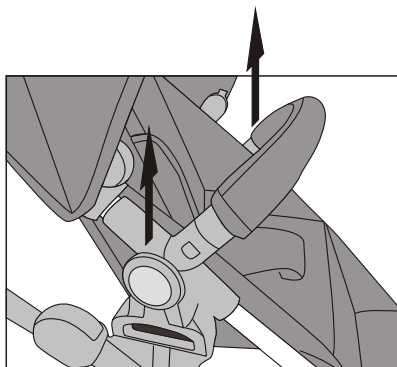

## To use safety belts

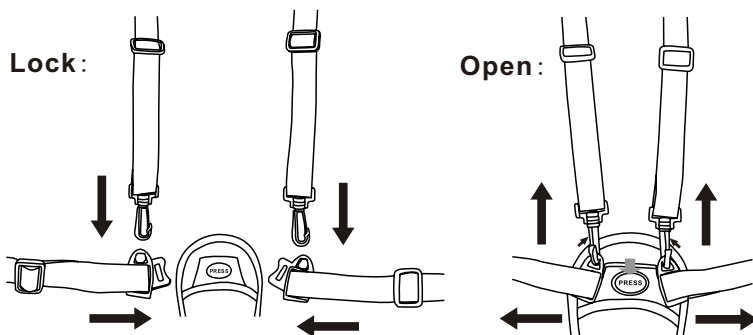

**WARNING:** When using the foot-muff please ensure the harness belts are put through the foot-muff holes,(2 of the shoulder, 2 of the waist & one of the crotch) first and then fastened. This must be done to ensure the safety of your child.

## To use bumper/ safety bar

**Install:** Hold the bumper bar, slide the bumper tips into the relative opening till hearing click sound, ensure that it's installed in place.

**Releasing the bumper bar:** Push two buttons of each side of the bumper bar while pull it out.

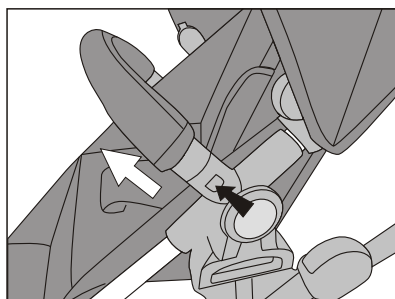
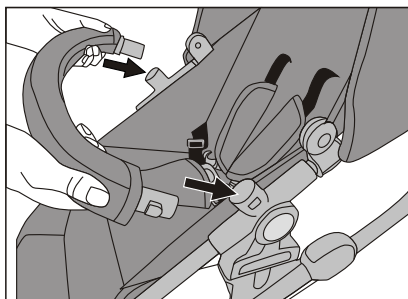

## Conversion between seat unit and carrycot

**WARNING:** Do not convert the seat unit with a child seated in it.

1. Change the seat unit into carrycot: Unlock the buckle A,B&C on the back of the seat unit. (show as P1)

2. Change the carrycot into seat unit: Lock the buckle A,B&C on the back of the seat unit. (show as P2)

**Important:** When convert the carry cot to seated mode, suggest to remove the seat unit from the chassis, if the buckles (B) underside the seat unit is not easier to fasten. Push the seat unit as per the picture showing, then fasten the buckles (B).

**Note: 1) Make sure that the seat unit supporting lever (E) is correctly fixed via the buckles (D) no matter you use the stroller as a seat unit or a carrycot.**

**2) Make sure that it is in level condition when use it as a carrycot.**

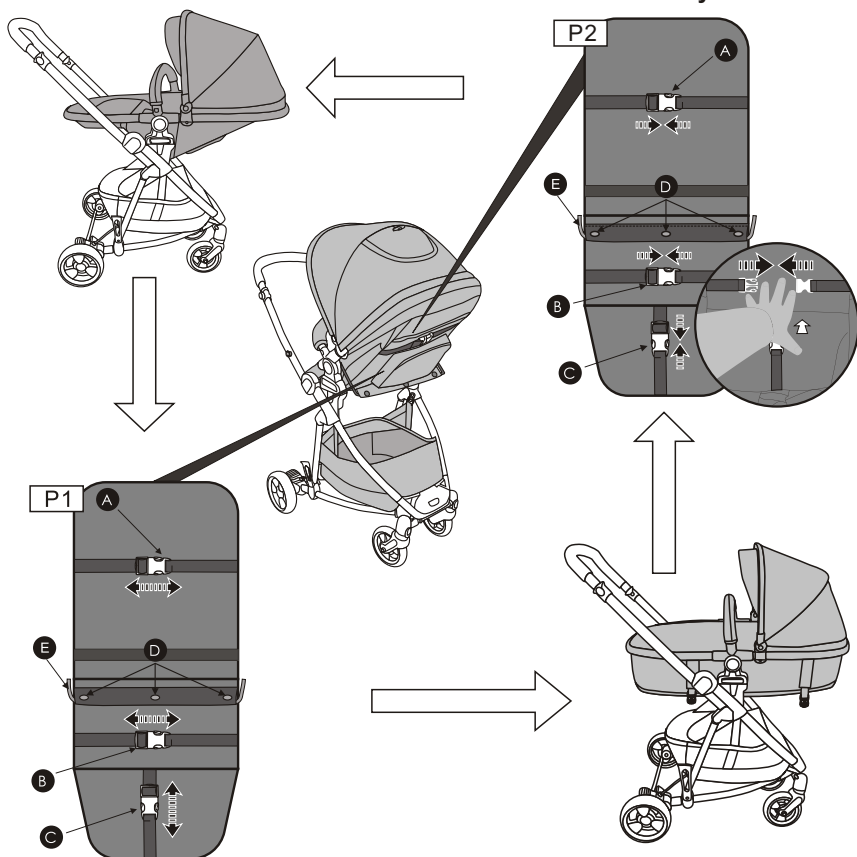

## Folding the stroller

**WARNING:** To avoid injury ensure that your child is kept away when unfolding and folding this stroller.

1. Remove the raincover and footcover (if fitted).
2. Change into seat unit model and the direction for the seat unit must be forward and adjust it into minimum angle when be folded.
3. Fold the canopy.
4. Press and hold the safety latch release button(1) on the right handle (at the same time) pull up both release latches(2).
5. Push the handle forwards until the buggy folds in half, attach the auto lock.

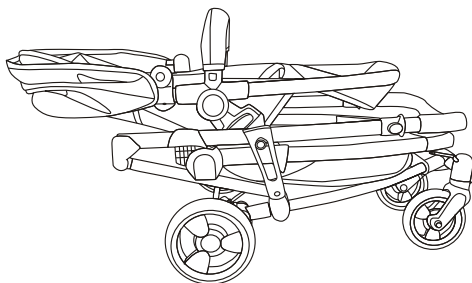
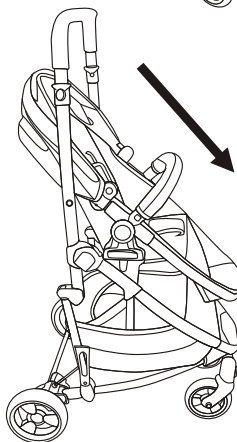
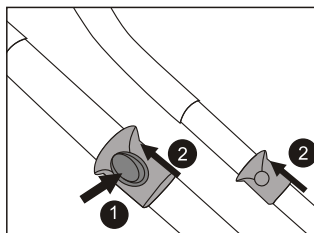
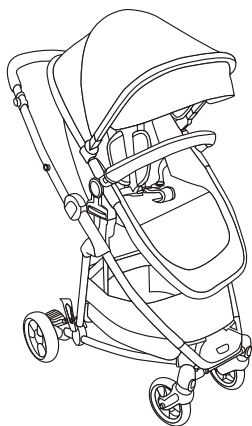



Company: [Leatherette-Prams.Co.Uk](http://Leatherette-Prams.Co.Uk)

Address: First Way, Wembley, Middlesex HA9 0JD

email: [info@leatherette-prams.co.uk](mailto:info@leatherette-prams.co.uk)