

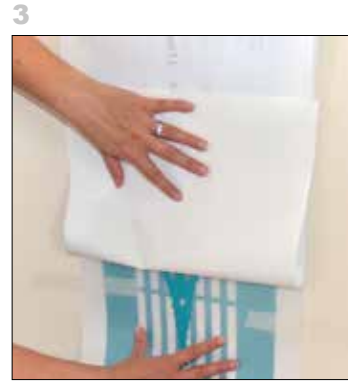

1
Cut away the optional section and, on a table or hard surface, rub through the application tape with the squeegee to ensure a good bond to the vinyl.



2
Tape the vinyl artwork to the wall in your chosen position with masking tape at the corners and horizontally across the centre.



3
Gently and slowly peel the printed backing sheet away from the vinyl at 180°, keeping the free edge flat to the wall.



4
If any detail comes away with the backing sheet, reverse and press vinyl and application tape together before continuing.



5
When you reach the centre tape, carefully cut away the top section of backing sheet and squeegee upwards from the middle.

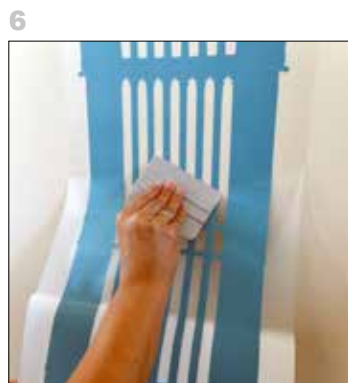

6
Remove the centre tape and gently peel the backing sheet downwards, and squeegee the sticker to your wall as before.



7
When applied, carefully but firmly rub the vinyl through the application layer with the edge of the squeegee to ensure good contact.



8
Starting with a top corner, peel back the application tape in a 45° direction, keeping the removed layer flush against the wall.

Leave for 15-20 minutes before moving to step 8 to allow the vinyl to adhere.



9
Finally, hold the shiny side of the backing sheet against the vinyl and rub again with the edge of the squeegee.



10
Remove the battery isolation strip and fix the clock to the wall with a picture pin.

The upper spot on the clock face gives the correct position for the pin.



12
If required, cut the optional footer section to size and stick to the skirting board.