

ENDON®

Geo Flush Light Fitting INSTRUCTION MANUAL

Safety Warnings

- This product is only suitable for connection to a 240V~50Hz supply in accordance with current IEE wiring regulations. It should be installed in accordance with local building regulations and is for domestic use only.
- Before installing your light fitting always switch off the mains supply and remove the appropriate fuse or switch off the appropriate circuit breaker before commencing installation.
- **This is a Class II, Double Insulated**  **product and must not be earthed.** The terminal blocks are supplied according to requirements of the fitting.
- This product contains delicate parts – be careful during handling and maintenance to avoid breakage.
- This light may be installed in Zones 1 and 2 and Outside Zones of a bathroom where water jets are not used for cleaning purposes. If installing in a bathroom, a 30mA RCD must be used in accordance with IEE Wiring Regulations and the Building Regulations. An electrician must be consulted if in any doubt about your own competency or meaning of bathroom “Zones”, “Equipotential Bonding” or “RCD”.
- If you are in any doubt about your competence please consult a qualified electrician.
- If any modification is made it will invalidate the warranty and may render the product unsafe.
- This product is not suitable for use with a dimmer switch.
- The LED light source of this luminaire is not replaceable; when the light source reaches its end of life the whole luminaire shall be replaced.

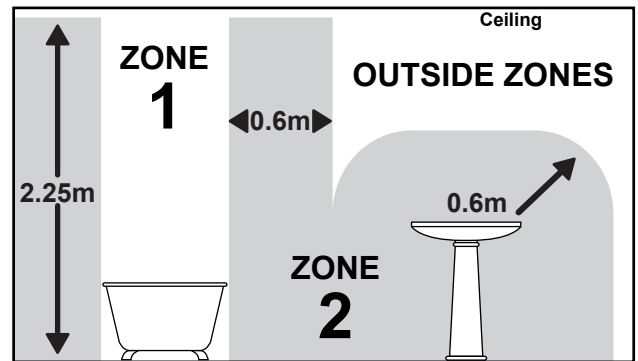

Care Information

- Allow 10 minutes to cool before replacing, adjusting or cleaning.
- Clean with a dry cloth only. Do not use liquid or abrasive cleaners on this product.

Assembly/ User Instructions

Before you start

Please read these instructions carefully before fitting and retain for reference. Check the packaging and make sure that you have all the required parts. Follow each assembly step in order to prevent incorrect assembly. Ensure that the product is fully assembled as illustrated before use.

The Light pack contains:

- Light fitting
- Terminal connection block(s)
- Fixing pack

The following tools may be required:

- Selection of cross and flat head screwdrivers.
- Electric drill and assorted drill bits.
- Wire strippers.
- Electrical insulation tape

These assembly diagrams are intended as a guide – if in doubt consult a qualified electrician.

1. Decide on the position of the light fitting, or remove existing light fitting. Take a note of the position of the electrical connections. Ensure there is a solid mounting surface, preferably a wooden joist or joist bridge to support the weight of the light fitting.
2. Remove the ceiling cover (A) from the product by removing the side screws (B).
3. Attach to the ceiling using the screws provided (C). Ensure there is a joist at the point of fixing to support the weight of the product. Take care to avoid damaging any concealed wiring and pipes.
4. Support your fitting and connect the house wiring to the terminal block – see expanded wiring details below.
NOTE: This is a Class II fitting and must NOT be earthed. Any loose terminal blocks – not secured to ceiling cup – should always be covered with 2 layers of good quality insulation tape.
5. Attach the product to the ceiling cover, by locating the screws in the bracket into the holes in the ceiling cover (D). When tightening the screws, ensure this is done in small, alternate increments so as not to damage the seal. Take care not to trap any wiring.
6. Turn on the power and test.

Assembly/ User Instructions

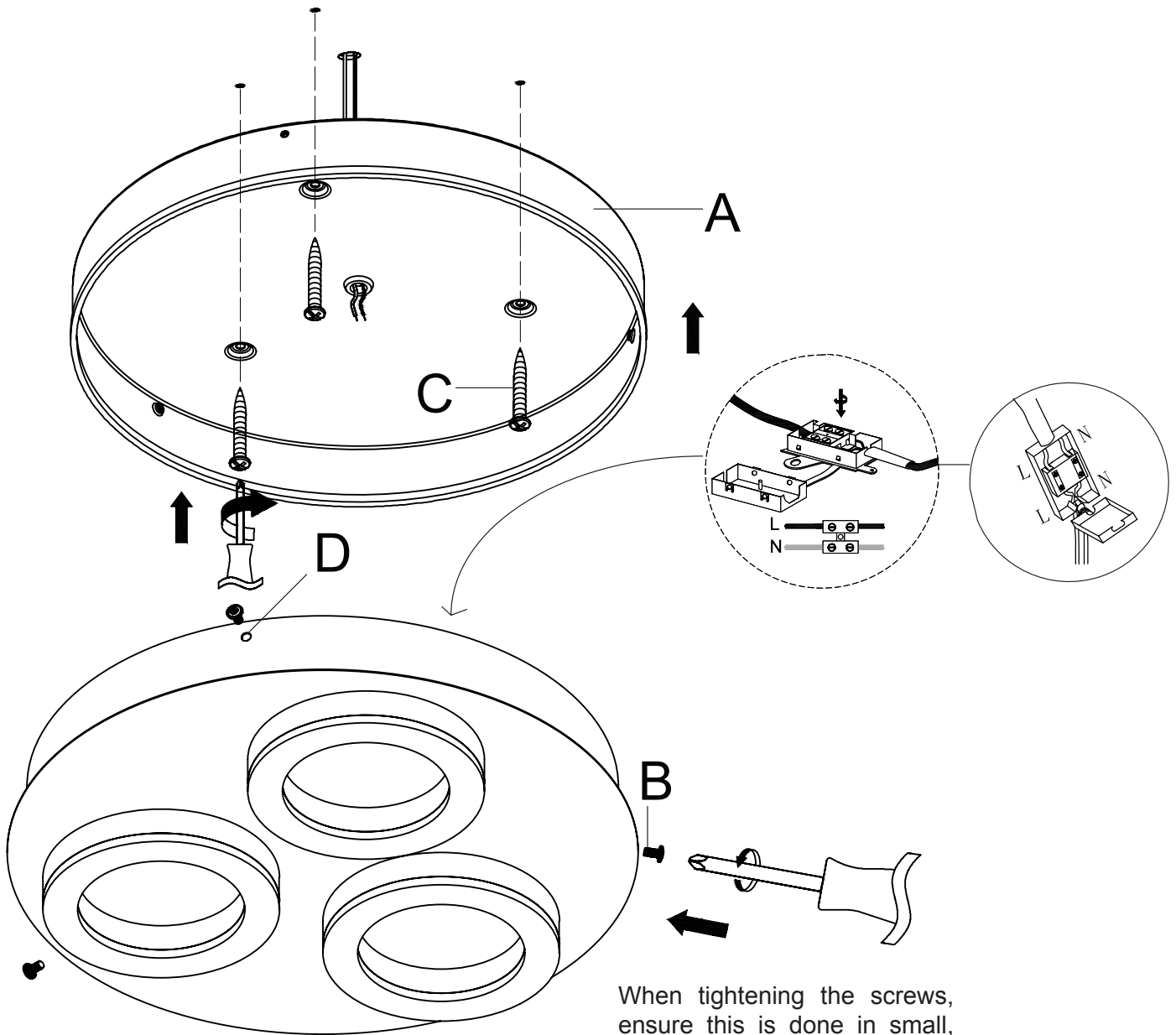

When tightening the screws, ensure this is done in small, alternate increments so as not to damage the seal.