



QUICK USER GUIDE

En

!!! Please refer to our website: www.geemarc.com for an up to date user guide, as there may be important updates and changes you need to be aware of !!!

Package Contents

- 1 x Speaker
- 1 x Micro USB charging cable
- 1 x Power adapter
- 1 x Instruction Manual

Important Safety Instructions

1. Read these instructions thoroughly and retain for future reference.
2. Do not expose this speaker to water, corrosive liquids or gases. Keep the speaker in a clean and dry place.
3. Do not use the speaker near windows or near sources of heat like radiators, gas stoves or any other apparatus that produces heat.
4. No naked flame sources, such as a lit candle, should be placed on or near the speaker.
5. Clean only with a soft and dry cloth.
6. Do not expose the speaker to rain or humidity.
7. Do not cover the speaker during use.
8. No user-serviceable parts inside. Do not open.
9. Keep this product away from children.

Over view

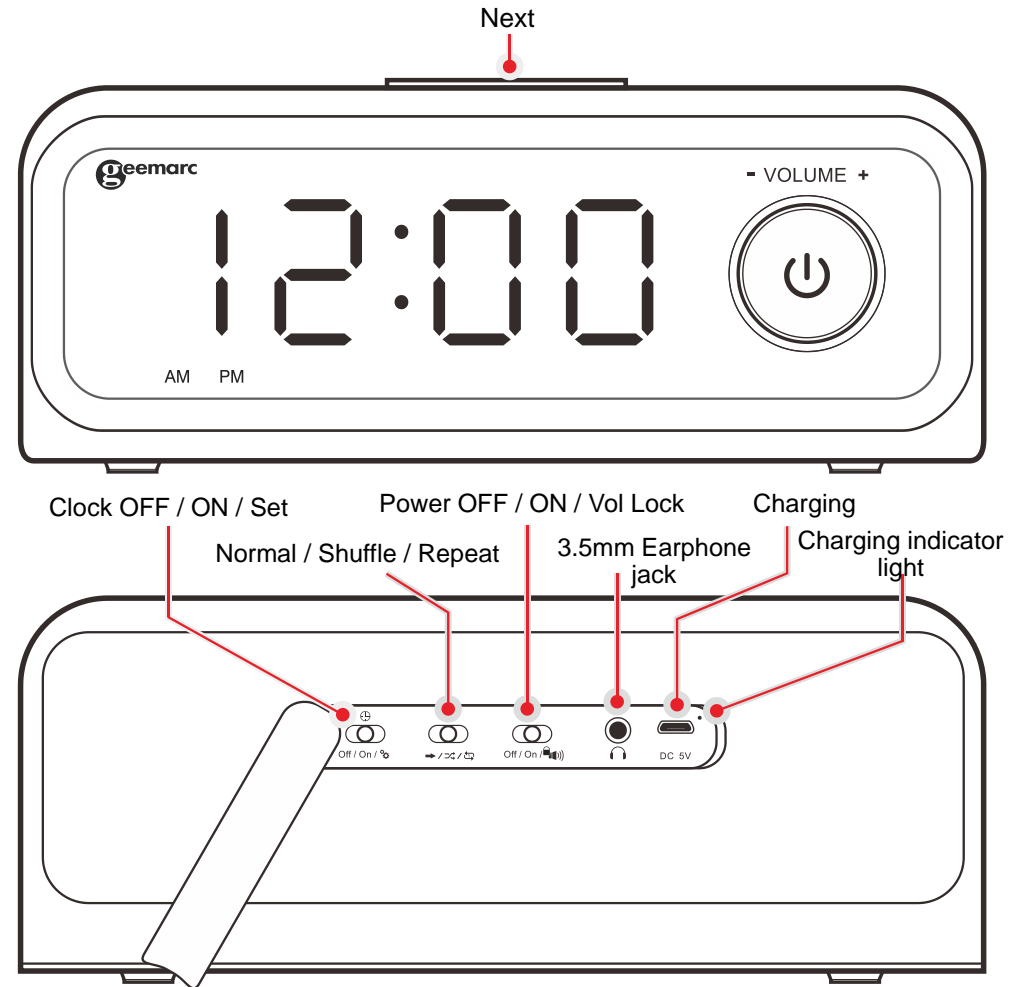

Charging the Battery

- Before using the speaker, fully charge the battery using the supplied USB cable. Plug the cable into any USB port that can supply power (Laptop, Computer, AC Charger, Car Charger, etc.).
- A red LED light indicates that the MP3 is charging, once fully charged the light will turn off.

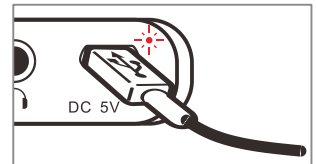

Power on/off

- Switch the "Power Off/On/Vol Lock" button to power on/off the unit.

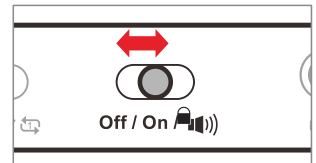

Clock Setting

- Toggle the “**clock off/on/set**” switch to set and enter clock mode.
- When the hours' digits flash, turn the volume knob clockwise or anticlockwise to adjust the hour.
- Once you're done adjusting the hour, press “**⏻**” to adjust the minutes. When the minutes' digits flash, turn the volume knob clockwise or anticlockwise to adjust the minutes.
- Once you're done setting the time, toggle the “**clock Off/On/set**” switch to **On**.
- You can also toggle the “**clock Off/On/set**” switch to **Off** to turn off the clock LED display.

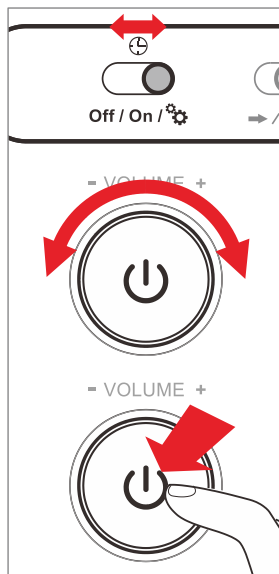



Hour format

- To choose between the 24h or 12h format, when in clock setting mode, press and hold the volume knob and turn it anticlockwise until the letters “**AM**” appear on the screen.
- To change from AM to PM, press and hold the volume knob and turn it for 3 seconds
- To switch back to the 24 h format, press and hold the volume knob and turn it until the letters “**PM**” disappear.

Upload/ Download Music files

- Before you can listen to music with the VisoTempo200, you first need to connect it to a computer / laptop using the supplied USB cable and download / upload your favourite music (MP3/WMA files).

Playing Music from your playlist

- When the power is on, press the “**⏻**” button (volume control button) to pause or play a song, the white led light of the knob will turn off when the music is on pause.
- Press the “**Next**”  button to skip to the next song.
- Turn the “Volume +/-”  knob to adjust the volume.
- Toggle the switch  to lock to lock the volume.

Play Setting mode

- Toggle the **Normal/Shuffle/Repeat** switch to choose between **Normal**, **Shuffle** and **Repeat** play mode.

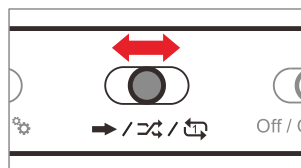

Using the headphone

- You can use a headset (3.5mm earphone jack) to listen to music. When a headset is plugged in, the outside sound will cut off automatically.

Specifications

LED Indicator	Status of the Speaker
Red LED light indicates	Under charging
Time format	24 H or 12H

Power source	3.7V / 4000mAh rechargeable battery
Memory	8G
Input	5V / 2A
Speaker output	2 x 5W
Dimensions	210*125*85mm
Format	support mp3 / WMA format

GUARANTEE

From the moment your Geemarc product is purchased, Geemarc guarantee is for the period of two years. During this time, all repairs or replacements (at our discretion) are free of charge. Should you experience a problem then contact our help line or visit our website at www.geemarc.com.

The guarantee does not cover accidents, negligence or breakages to any parts. The product must not be tampered with or taken apart by anyone who is not an authorized Geemarc representative.

The Geemarc guarantee in no way limits your legal rights.

IMPORTANT: YOUR RECEIPT IS PART OF YOUR GUARANTEE AND MUST BE RETAINED AND PRODUCED IN THE EVENT OF A WARRANTY CLAIM.

Please note: The guarantee applies to the United Kingdom only.



DECLARATIONS:

CE Directives

Geemarc Telecom SA hereby declares that this product is in compliance with the essential requirements and other relevant provisions of the RED 2014/53/UE.

The CE declaration of conformity may be consulted at www.geemarc.com

Recycling Directives

The WEEE (Waste Electrical and Electronic Equipment) has been put in place for the products at the end of their useful life are recycled in the best way.

When this product is finished with, please do not put it in your domestic waste bin. Please use one of the following disposal options:

- Remove the batteries and deposit them in an appropriate WEEE skip.

Deposit the product in an appropriate WEEE skip.

- Or, hand the old product to the retailer. If you purchase a new one, they should accept it. If you respect these instructions you ensure human health and environmental protection.



For product support and help visit our website at www.geemarc.com
United Kingdom: 5B Swallow Court, Swallowfields,
Welwyn Garden City, Hertfordshire, AL7 1SB, UK
telephone **01707 387602** lines are open 09h00 to 16h00 Mon to Fri