

S-Mount 12mm F4.0 Lens

SVL-F1240FM

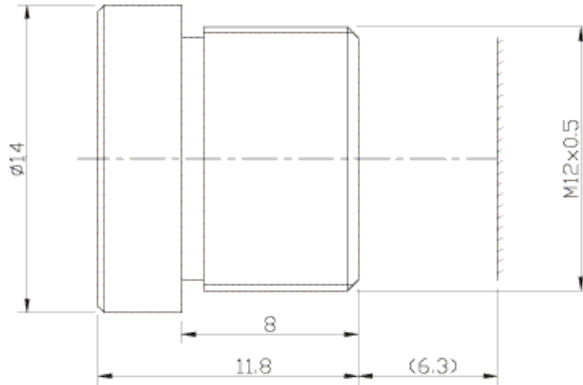

Focal Length	12mm
F Number	f4.0
Iris	Non Adjustable
Mount	M12
Format	2/ 3"
IR Block	No IR Block
Resolution	10MP
Horizontal Field of View	40 Degrees
Distortion	<-1.2%
Back Focus	8mm
Working Distance	∞ ~ 0.1m
Wavelength	400nm-950nm



MTF Curves

