

MV-CH089-10UM/UC

8.9 MP 1" CMOS USB3.0 Area Scan Camera



GEN*i*CAM

US3™
VISION

Introduction

MV-CH089-10UM/UC camera adopts Sony IMX267 sensor to provide high-quality image. It uses USB3.0 interface to transmit non-compressed images in real time with max. frame rate reaching 32 fps.

Key Feature

- Supports auto and manual adjustment for gain, exposure control, white balance, LUT, Gamma correction, etc.
- Supports hardware triggering, software triggering and free run mode
- Adopts M2 screw holes for securing cable that connects USB3.0 interface
- Compatible with USB3 Vision Protocol, GenICam Standard, and the third-party software based on these protocol and standard

Available Model

Mono Camera: MV-CH089-10UM

Color Camera: MV-CH089-10UC

Applicable Industry

Electronic semiconductor, factory automation, bottle inspection, medical packaging, etc.

Sensor Quantum Efficiency

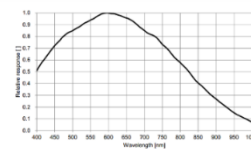

MV-CH089-10UM

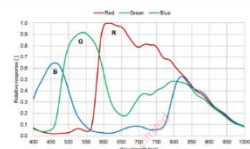

MV-CH089-10UC

Dimension

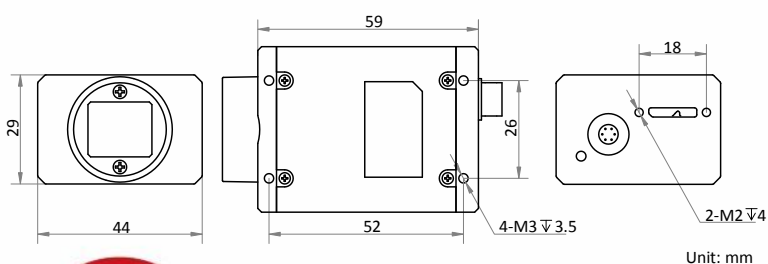

Specification

Model	MV-CH089-10UM	MV-CH089-10UC
Camera		
Sensor type	CMOS, global shutter	
Sensor model	Sony IMX267	
Pixel size	3.45 μm × 3.45 μm	
Sensor size	1"	
Resolution	4096 × 2160	
Max. frame rate	32 fps @4096 × 2160	
Dynamic range	72.5 dB	
SNR	40.1 dB	
Gain	0 dB to 20 dB	
Exposure time	50 μs to 10 s	
Shutter mode	Off/Once/Continuous exposure mode	
Mono/color	Mono	Color
Pixel format	Mono 8/10/10p/12/12p	Mono 8/10/12, Bayer GB 8/10/10p/12/12p, YUV422Packed, YUV422_YUYV_Packed, RGB8
Acquisition mode	Continuous mode and SingleFrame mode	
Binning	Supports 1 x 2, 2 x 1, 1 x 4, 4 x 1, 2 x 2, 2 x 4, 4 x 2, 4 x 4	
Decimation	Supports 1 x 2, 2 x 1, 2 x 2	
Reverse image	Supports horizontal and vertical reverse image output	
Image buffer	128 MB	
Electrical features		
Data interface	USB3.0	
Digital I/O	6-pin Hirose connector provides power and I/O, including opto-isolated input x 1 (Line0), opto-isolated output x 1(Line1), bi-directional non-isolated I/O x 1 (Line2)	
Power supply	5 VDC to 15 VDC, supports USB3.0 power supply	
Power consumption	< 3.27 W@5 VDC	
Structure		
Lens mount	C-Mount	
Dimension	44 mm × 29 mm × 59 mm (1.7" × 1.1" × 2.3")	
Weight	Approx. 100 g (0.2 lb.)	
Ingress protection	IP30 (under proper lens installation and wiring)	
Temperature	Working temperature: 0 °C to 50 °C (32 °F to 122 °F) Storage temperature: -30 °C to 70 °C (-22 °F to 158 °F)	
Humidity	20% to 80% RH, without condensation	
General		
Client software	MVS or third-party software meeting with USB3.0 Vision Protocol	
Operating system	32/64-bit Windows XP/7/10, 32/64-bit Linux	
Compatibility	USB3 Vision, GenICam	
Certification	CE, FCC, RoHS, KC	



SCORPION
VISION LIMITED

www.scorpionvision.co.uk +44 (0)1590 679333
sales@scorpion.vision