

# MV-CH120-10UM/UC

12 MP 1.1" CMOS USB3.0 Area Scan Camera



GEN*i*CAM

USB<sup>TM</sup>  
VISION

## Introduction

MV-CH120-10UM/UC camera adopts Sony® IMX304 sensor to provide high-quality image. It uses USB3.0 interface to transmit non-compressed images in real time, and its max. frame rate can reach 23.1 fps in full resolution.

## Key Feature

- Supports auto and manual adjustment for gain, exposure control, LUT, Gamma correction, etc.
- Supports hardware triggering, software triggering and free run mode.
- Adopts M2 screw holes for securing cable that connects USB3.0 interface.
- Compatible with USB3 Vision Protocol, GenICam Standard, and the third-party software based on these protocol and standard.

## Dimension

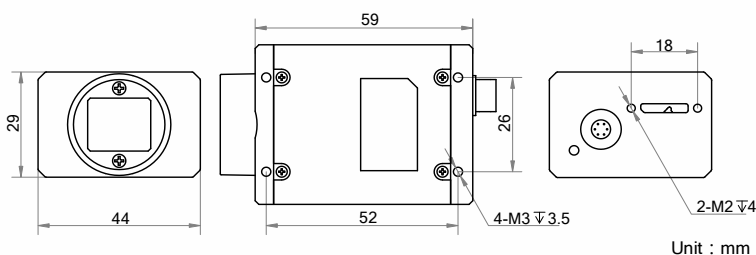

## Available Model

- Mono camera: MV-CH120-10UM
- Color camera: MV-CH120-10UC

## Applicable Industry

Electronic semiconductor, factory automation, liquor and beverage, medicine packing, etc.

## Sensor Quantum Efficiency

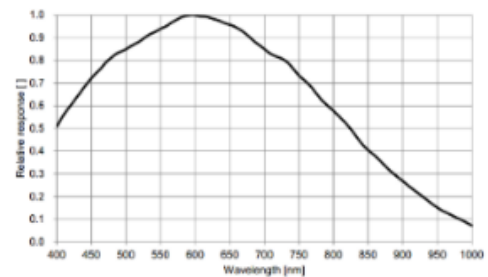

MV-CH120-10UM

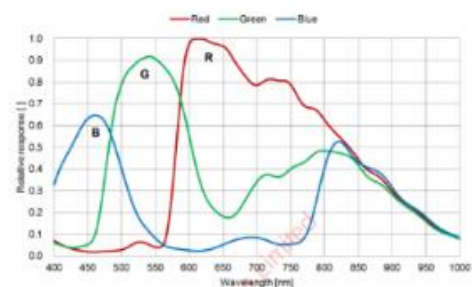

MV-CH120-10UC



## Specification

Model	MV-CH120-10UM	MV-CH120-10UC
<b>Camera</b>		
Sensor type	CMOS, global shutter	
Sensor model	Sony® IMX304	
Pixel size	3.45 µm × 3.45 µm	
Sensor size	1.1"	
Resolution	4096 × 3000	
Max. frame rate	23.1 fps @4096 × 3000	
Dynamic range	72.2 dB	
SNR	40.2 dB	
Gain	0 dB to 20 dB	
Exposure time	UltraShort exposure mode: 1 µs to 14 µs	
	Standard exposure mode: 15 µs to 10 s	
Exposure mode	Off/Once/Continuous exposure mode	
Mono/color	Mono	Color
Pixel format	Mono 8/10/10p/12/12p	Mono 8/10/12, Bayer GB 8/10/10p/12/12p, YUV422Packed, YUV422_YUYV_Packed, RGB 8, BGR 8
Binning	Supports 1 × 1, 2 × 2, 4 × 4	
Decimation	Supports 1 × 1, 2 × 2, 4 × 4	
Reverse image	Supports horizontal and vertical reverse image output	
Image buffer	128 MB	
<b>Electrical features</b>		
Data interface	USB3.0, compatible with USB2.0	
Digital I/O	6-pin Hirose connector provides power and I/O, including opto-isolated input × 1 (Line 0), opto-isolated output × 1 (Line 1), and bi-directional non-isolated I/O × 1 (Line 2)	
Power supply	12 VDC, supports USB3.0 power supply	
Power consumption	Typ. 3.5 W@5 VDC (USB3.0 provides power supply)	
<b>Structure</b>		
Lens mount	C-Mount	
Dimension	44 mm × 29 mm × 59 mm (1.7" × 1.1" × 2.3")	
Weight	Approx. 100 g (0.2 lb.)	
Ingress protection	IP30 (under proper lens installation and wiring)	
Temperature	Working temperature: 0 °C to 50 °C (32 °F to 122 °F)	
	Storage temperature: -30 °C to 70 °C (-22 °F to 158 °F)	
Humidity	20% to 80% RH, non-condensing	
<b>General</b>		
Client software	MVS or third-party software meeting with USB 3.0 Vision Protocol	
Operating system	32/64-bit Windows XP/7/10, 32/64-bit Linux and 64-bit MacOS	
Compatibility	USB 3.0 Vision, GenICam	
Certification	CE, FCC, RoHS, KC	



**SCORPION**  
VISION LIMITED

www.scorpionvision.co.uk +44 (0)1590 679333  
sales@scorpion.vision