

Spring Pin Load Cell BL

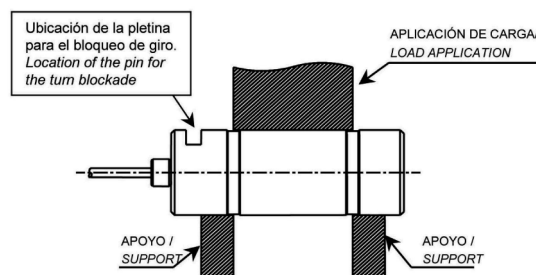

airpes®

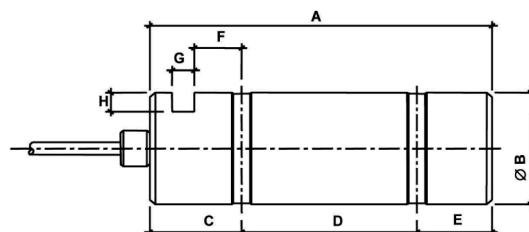

Model BL

General information

The BL model of load cells have been specially designed to work with traction or compression with element detecting a double shear.

Its most generalised application is dedicated to pulleys, as system of limitation, or weighing.

Construction in alloyed steel and anticorrosive treatment of chemical nickel.

Leak-tightness IP-67

Capacities from 500Kg to 100T

Available in stainless steel.

Characteristics

Sensitiveness: $2 \pm 0,1\% mV/V$

Vmin: $E_{max}/10000$

Voltage of feeding: $5 \div 15V$

Resistance at input: $700 \pm 10\Omega$

Resistance at output: $700 \pm 3\Omega$

Compensated margin of temperature: $-10^{\circ}C$ a $+40^{\circ}C$

Resistance of insulation: $>5000M$

COTA	mm.
A	
$\varnothing B$	
C	
D	
E	
F	
G	
H	
Capacidad/ Capacity	kg.