

BD_SW_3BC_83

Suzuki 8R – 2024 onwards
Right side , Rain – Stop/Run - Start
3 button handlebar race switch for fitting directly onto the brake master cylinder

This switch is a direct replacement for the standard right switch assembly found on the Suzuki 8R. Designed for use on race bikes which need an additional latching switch for the rain light, or need to save space on the handlebar.

The rain light is pre-wired into the original brake switch wiring so control of the 'stop light' can be achieved simply by pressing the yellow button.



No modification of the bike wiring is necessary, this kit plugs directly into the standard loom via the 13 way plug

NOTE : The standard right switch on the 8R comprises both the switch assembly and throttle grip sensors. When fitting this product you will also need to source an aftermarket 'stand alone' throttle grip.

Matching left switch - BD-SW-3BC-82



Function:

RED	RUN/STOP	Latching
GREEN	START	Momentary
YELLOW	RAIN	Latching

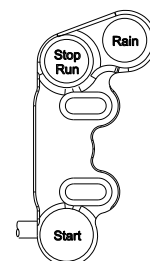

Electrical / Mechanical Characteristics

Wire.....	Type 55 / 24	Dia (handlebar)	22mm (7/8")	
Switch sealing.....	IP67	Max width	20.5	mm
Housing.....	Aluminium	Min width at centre	20.0	mm
Coating.....	Black anodise	Weight	85	g

Ordering Information

Part No.	Connector	Description
BD-SW-3BC-83-xxx	Plug n Play	3 way switch Suzuki 8R + Choice of clamp
		Xxx - Choose one clamp of your choice with each switch purchase, see page 2

Mounting

These switches mount directly onto our own brake pump clamp(s) and are adjustable left / right to suit the rider

Several clamps are available to suit most popular brakes
BR-A – 32mm in-line bolts as found on most standard bikes - Locates our switch to the right of the brake mount bolts **

BR-N – 32mm in-line bolts – Locates our switch to the left of the brake mount bolts **

BR-B – 30mm offset bolts to suit Brembo XR / GP brake pump

BR-F – 30mm in-line bolts to suit Accosato / Hel brake pump

BR-J – 32mm offset bolts to suit Beringer brake pump

BR-G - Generic clamp for direct handlebar mounting.

Specify your clamp at the time of ordering. Clamps are sold separately so there is no need to replace the switch if you change your brake pump.

We will supply clamp **BR-A** to suit the standard brake, or you can choose from any one of the above as a free alternative.

** Additional info to help you choose between BR-A and BR-N can be found [here](#).

IMPORTANT

Tighten the UPPER bolt first to achieve metal to metal contact, then use the lower bolt to clamp onto the handlebar – Except BR-F and BR-J which have equal gap for upper and lower



1.0mm of gap – Used for tightening the clamp.
 21.5 > 22.2mm dia bar

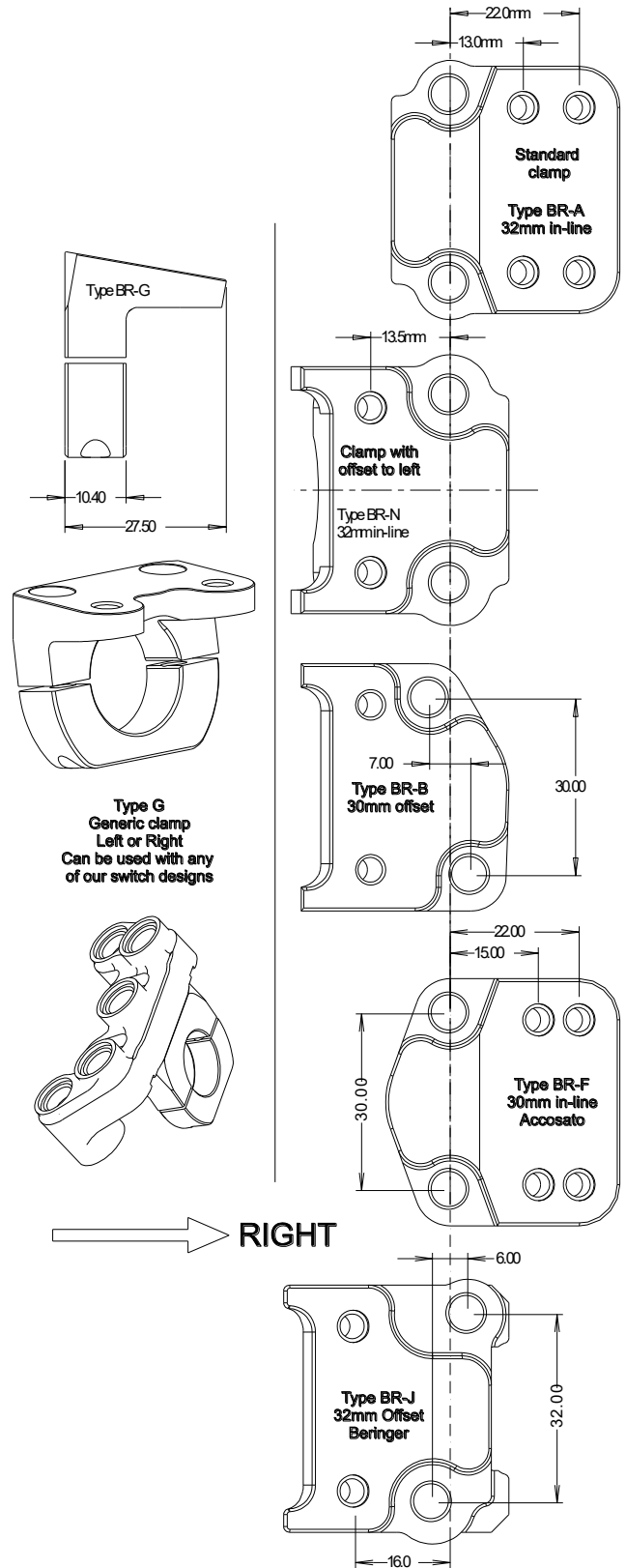

Clamps are also sold separately so there is no need to replace the switch if you change your brake.