

BD-SW-3BC-93

Yamaha , R9 2025 onward / MT09 2024 onward
Right side , Mode – Stop/Run - Start
3 button handlebar race switch for fitting directly onto the brake master cylinder

This switch is a direct 'Plug n Play' replacement for the standard right switch assembly found on the R9 and MT09 and mounts directly onto the brake using one of our dedicated clamps.

NOTE : The standard switch is integrated into the throttle grip housing so we also offer a 'billet' aluminium product KT170 to re-house the standard sensor as an additional product (not supplied in this switch kit), or you could choose an alternative aftermarket throttle grip.

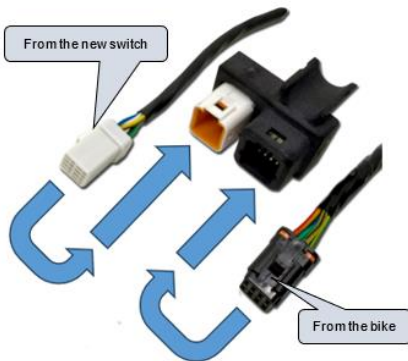

No modification of the bike wiring is necessary, this kit plugs directly into the standard loom via our dedicated interface module.

KT170 Billet aluminium throttle grip housing is available as a separate item.



Matching left switch BD-SW-7BC-92
 for R9 or BD-SW-6BC-92 for MT09



Electrical / Mechanical Characteristics

Wire..... Type 55 / 24
 Switch sealing..... IP67
 Housing.....Aluminium

Coating.....Black anodise
 Dia (handlebar)22mm (7/8")

Ordering Information

Part No.	Connector	Description
BD-SW-3BC-93-xxx	Plug n Play	3 way switch Yamaha R9 , MT09 + Choice of clamp
		Xxx - Choose one clamp of your choice with each switch purchase, see page 2

Mounting

These switches mount directly onto our own brake pump clamp(s) and are adjustable left / right to suit the rider

Several clamps are available to suit most popular brakes
BR-A – 32mm in-line bolts as found on most standard bikes - Locates our switch to the right of the brake mount bolts **

BR-N – 32mm in-line bolts – Locates our switch to the left of the brake mount bolts **

BR-B – 30mm offset bolts to suit Brembo XR / GP brake pump

BR-F – 30mm in-line bolts to suit Accosato / Hel brake pump

BR-J – 32mm offset bolts to suit Beringer brake pump

BR-G - Generic clamp for direct handlebar mounting.

Specify your clamp at the time of ordering. Clamps are sold separately so there is no need to replace the switch if you change your brake pump.

We will supply clamp **BR-A** to suit the standard brake, or you can choose from any one of the above as a free alternative.

** Additional info to help you choose between BR-A and BR-N can be found [here](#).

IMPORTANT

Tighten the UPPER bolt first to achieve metal to metal contact, then use the lower bolt to clamp onto the handlebar – Except BR-F and BR-J which have equal gap for upper and lower



1.0mm of gap – Used for tightening the clamp.
 21.5 > 22.2mm dia bar

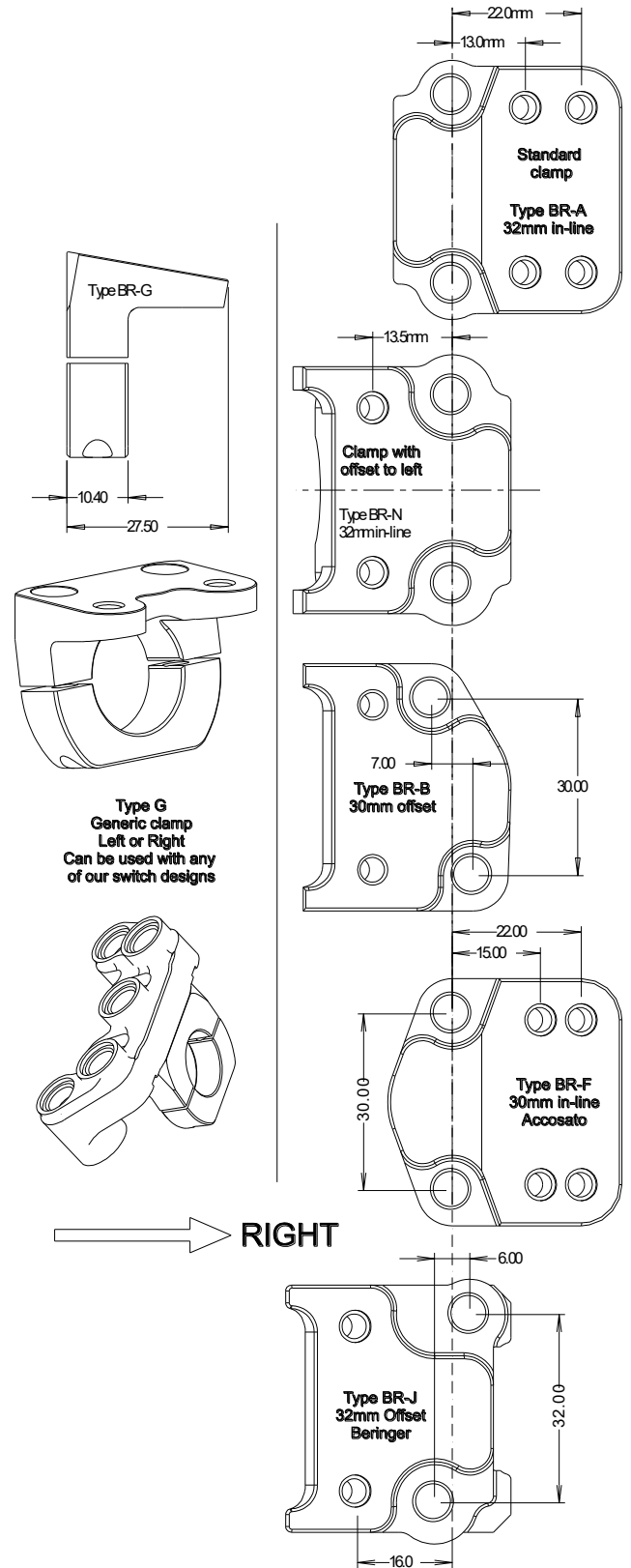

Type G
 Generic clamp
 Left or Right
 Can be used with any
 of our switch designs

Clamps are also sold separately so there is no need to replace the switch if you change your brake.