

**BD_SW_5BC_05 Ducati 1199R (2015 onwards) 1199 SL , 1299 , 1299 SL – Left side
Mode Up/Down , Select Flipper +/-
5 button - Type C for clutch master cylinder mounting.**

This switch is a direct replacement for the standard left hand switch assembly found on the bikes listed above.

The set is specifically designed for track use where the turn signals and lights controls are not needed.

No modification of the bike wiring is necessary as this plugs directly into the 8 way and 3 way wiring loom connectors.

For customers who want to use the flasher (Lap time SET function) you will need the additional right side 3 way switch assembly BD-SW-3BC-06 (see page 2)

Use the two slotted M5 bolts to adjust left / right to best suit the rider.

No modification of the bike wiring is necessary, this kit plugs directly into the connectors of the standard loom and also provides wiring for the standard clutch switch.



Mounting - These 'Type C' switches mount directly onto our own clutch master cylinder clamps, replacing the original part. All are fully adjustable left / right to suit the rider. As standard we supply one clamp free of charge per switch to suit the standard bike but you are free to choose any alternative clamp to suit your bike at the time of ordering.

Clamps

CL-A – To suit 32mm in-line clamp bolts

CL-B – To suit 30mm offset bolts

CL-F – To suit 30mm in-line bolts as found on Accosato clutch posts.

BR-G - Generic clamp to suit any 22mm handlebar

These clamp designs use far less space on the handlebar than conventional switch bodies and are fully adjustable.

Several clamps are available (see full 'Type C' data sheet for list of options), but as standard we will supply the **CL-A** clamp to suit 32mm in-line clamp bolts as standard on the Ducati

Clamps are also sold separately so there is no need to replace the switch if you change your clutch master cylinder.

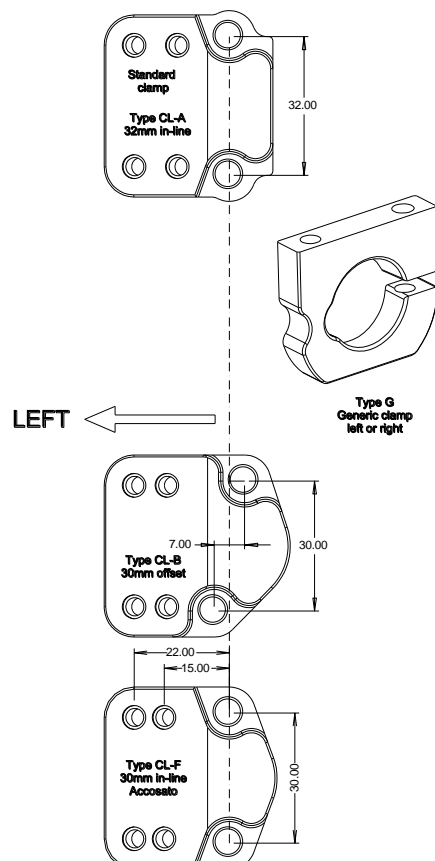

IMPORTANT
Tighten the UPPER bolt first to achieve metal to metal contact, then use the lower bolt to clamp onto the handlebar

0.5mm of gap – Used for tightening the clamp.
21.5 > 22.2mm dia bar

Electrical connection

No modification of the bike wiring is necessary, this kit plugs directly into the connectors of the standard loom.

NOTE – The right and left side switches link together via the 2 way connector with **YELLOW** band

Switch functions

	Colour	Text on switch	Function
1	Green	∧	UP function originally found on the flipper switch
2	Black	MODE	Dash control mode function switch - up
3	White	SET	Dash control set function
4	Black	MODE	Dash control mode function switch - down
5	Green	∨	DOWN function originally found on the flipper switch

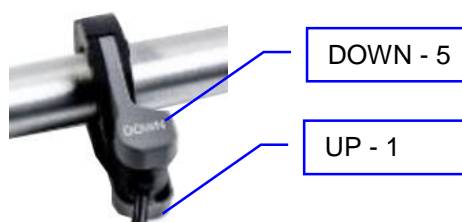
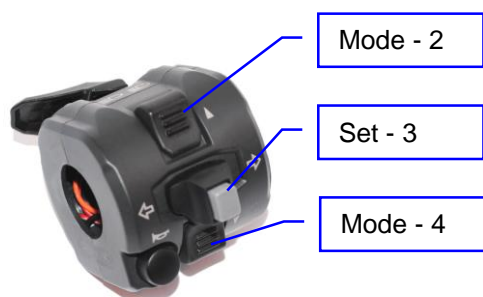
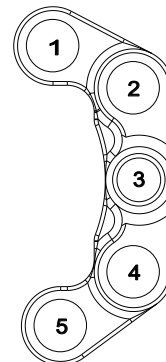

Caution: Do not press button 2 and 4 at the same time

Compatible right switch

BD_SW_3BC-06
 Stop/Run / Lap Set / Start



Electrical / Mechanical Characteristics

Wire..... Type 55 / 24
 Switch sealing..... IP67
 Housing.....Aluminium

Coating.....Black anodise
 Dia (handlebar)22mm (7/8")
 Wiring..... Plug n play

Ordering Information

Part No.	Connector	Description
BD-SW-5BC-05-G	Plug n Play	5 way right handlebar switch – Ducati 1199R , SL , 1299 with 32mm in-line clamp CL-A
BD-SW-5BC-05	n/a	Replacement switch pod, excluding clamp
BR-G	n/a	Generic clamp
CL-A	n/a	Replacement 32mm in-line clamp for clutch
CL-B	n/a	Replacement 30mm Offset clamp for clutch
CL-F	n/a	Replacement 30mm in-line clamp for clutch - Accosato