

## BD\_SW\_4B\_SPxx 4 button handlebar race switches

This switch set may be fitted to any race or road motorcycle. Four individual sealed switches are held in a machined aluminium enclosure offering high levels of crash protection as well as electrical integrity.

The user is free to choose the colour and type of switch in any of the 4 locations at the time of ordering.

Custom laser engraving is available as an extra cost, the default version has no markings to give the user greater freedom of use.

Although supplied without any connector, we can fit almost any connector as an extra cost.



### Switch types

Fill in the form below

- Switch type
  - a. Latching = Push to ON, then Push to OFF
  - b. Momentary 'NO' with normally open circuit = Push and hold to ON
  - c. Momentary 'NC' with normally closed circuit = Push and hold to OFF
  - d. Alternate momentary with one normally closed circuit and one normally open, these reverse when pressed.
- **Switch colour** – Black / Blue / Green / Red / White / Yellow

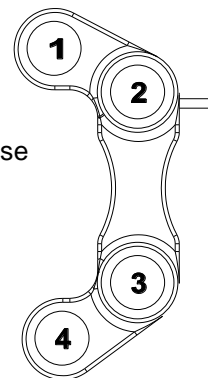

Each switch is independently wired and isolated from all other switches.

	Switch type	Colour
1		
2		
3		
4		

	Position selection
Left / Right	

### Example layout

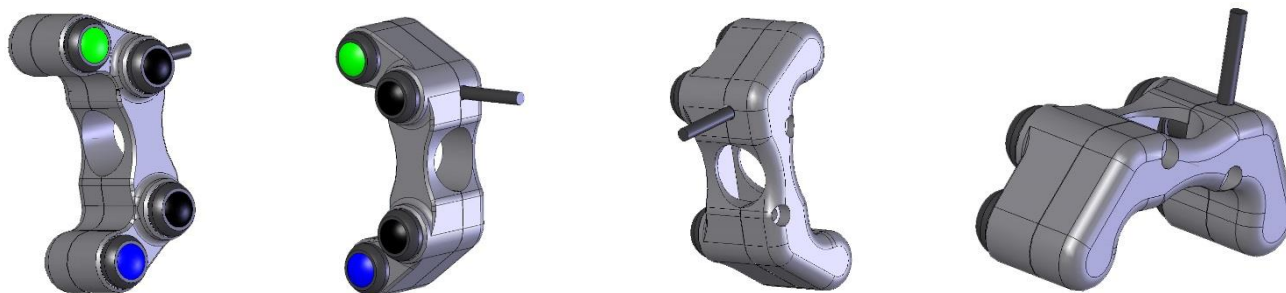

### Electrical / Mechanical Characteristics

Wire..... Type 55 / 24  
 Switch sealing..... IP67  
 Housing..... Aluminium  
 Coating..... Black anodise

Dia (handlebar) .....22mm (7/8")  
 Engraving..... none  
 Current (max) .....3 Amp

### Ordering Information

Part No.	Connector	Cable	Description
BD-SW-4B-XX	none	500mm	4 way handlebar switch to suit all race motorcycles