

BD_SW_4BC_37 Kawasaki ZX10 RR – 2021 on, 4 button, Mode Up-Down, Reset, Right > Handlebar race switches for direct clutch post mounting.

This switch is designed for use on race/track bikes where the normal road bike control functions are no longer needed

The aluminium assembly has been ergonomically designed for easy use and encompasses 4 momentary switches as described below with direct mounting onto the clutch post to save handlebar space.

The offset design moves the **RESET** function uppermost to ensure clearance when using a thumb brake below the handlebars.

Use the two slotted M5 bolts to adjust left / right to best suit the rider.

For use with the standard ECU and wiring only. For KIT ECU/Wiring please use part number [BD-SW-7BC-37](#)

**Function:**

1	Blue	RESET
2	Green	UP - Mode
3	Black	Right - function
4	Green	DOWN - Mode

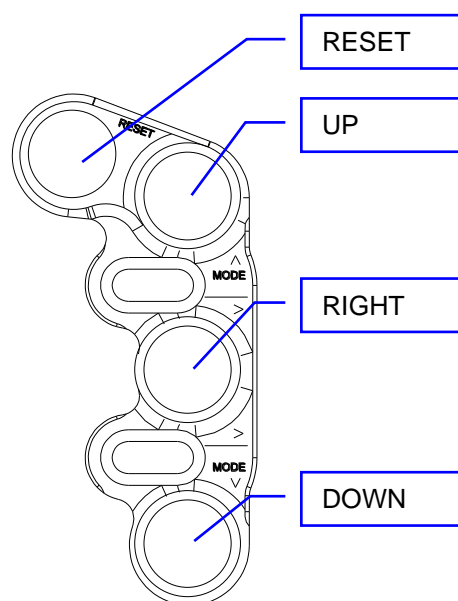
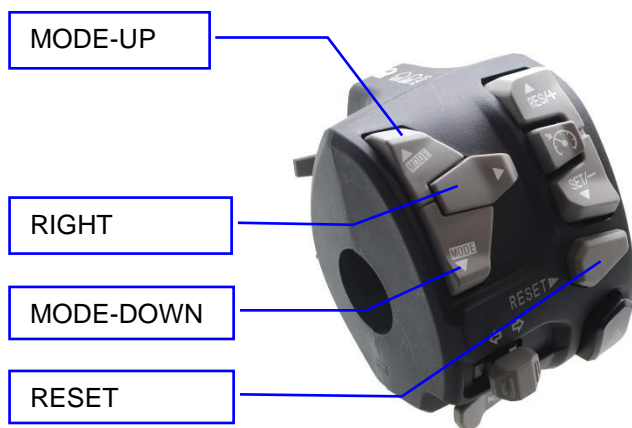
**Electrical / Mechanical Characteristics**

Wire..... Type 55 / 24
Switch sealing..... IP67
Housing..... Aluminium

Coating..... Black anodise
Wire length Same as standard

Ordering Information

Part No.	Connector	Description
BD-SW-4BC-37-x	Plug n Play	4 way handlebar switch to suit ZX10 RR 2021 onward + Clamp x - Choose appropriate clamp from the parts listed on page 3 and 4. One free clamp per switch assembly

Bike Sport Developments Ltd

The Old Barn, Greatworth Hall, Greatworth, Oxon, OX17 2DH - UK

Tel 0044 (0)1327 263942 – mail@bikesportdevelopments.co.uk / www.bikesportdevelopments.co.uk



Electrical connection

No modification of the bike wiring is necessary, this kit plugs directly into the connectors of the bike. 100% 'plug and play'.

Mounting - These switches mount directly onto our own clutch post clamp and are adjustable left / right to suit the rider

Several clamps are available (see page 3 for all options but as standard we will supply the **CL-K** clamp to suit 36mm in-line clamp bolts as standard on the Kawasaki

Clamps are also sold separately so there is no need to replace the switch if you change your clutch post.



IMPORTANT

Tighten the UPPER bolt first to achieve metal to metal contact, then use the lower bolt to clamp onto the handlebar

1.0mm of gap – Used for tightening the clamp.
21.5 > 22.2mm dia bar

Matching right side products

BD-SW-4BC-36 This 4 way right switch provides the Stop/run, Start, Select functions as well as a spare latching on/off yellow switch for use with any rain light wiring on the bike.

This also clamps to the standard brake pump to save space on the bars with a choice of clamps to suit whatever brake pump you have fitted.



KT165 – Billet aluminium throttle housing to enclose the standard sensor element within a more compact and stronger casing. This product also eliminates the unusual negative free play in the standard housing.

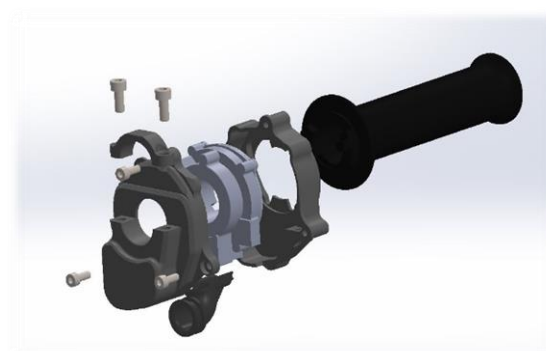

Left side clutch clamps

Mounting - These 'Type C' switches mount directly onto the clutch perch using our dedicated clamp CL-K, or direct to the handlebar using the BR-G generic '2 piece' clamp.

Clamps

CL-A – To suit 32mm in-line clamp bolts – To suit the standard clutch and Brembo RC

CL-K – To suit 36mm in-line bolts as found on Kawasaki

CL-B – To suit 30mm offset bolts – Brembo XR , XA , GP

CL-F – To suit 30mm in-line bolts as found on Accosato / Hel

CL-J – To suit 32mm offset bolts as found on Beringer

BR-G - Generic clamp for direct handlebar mounting.

We will supply clamp **CL-K** to suit the standard bike

These clamp designs use far less space on the handlebar than conventional switch bodies and are fully adjustable.

Mounting - These switches mount directly onto our own clutch post clamp and are adjustable left / right to suit the rider



0.5mm of gap – Used for tightening the clamp.
21.5 > 22.2mm dia bar

IMPORTANT CL-A, CL-B, CL-K
Tighten the UPPER bolt first to achieve metal to metal contact, then use the lower bolt to clamp onto the handlebar

Clamps are also sold separately so there is no need to replace the switch if you change your clutch post.

