

Installation Guide

Made-to-Order Wardrobes

kelvin[®]
direct

www.kelvindirect.co.uk

Wardrobe Components

kelvin[®]
direct

Panel Installation

kelvin[®]
direct



End Panel / Lid
2750 x 650mm

Lid panel will be edged all 4 sides.



Support Fillets



Top & Bottom Track

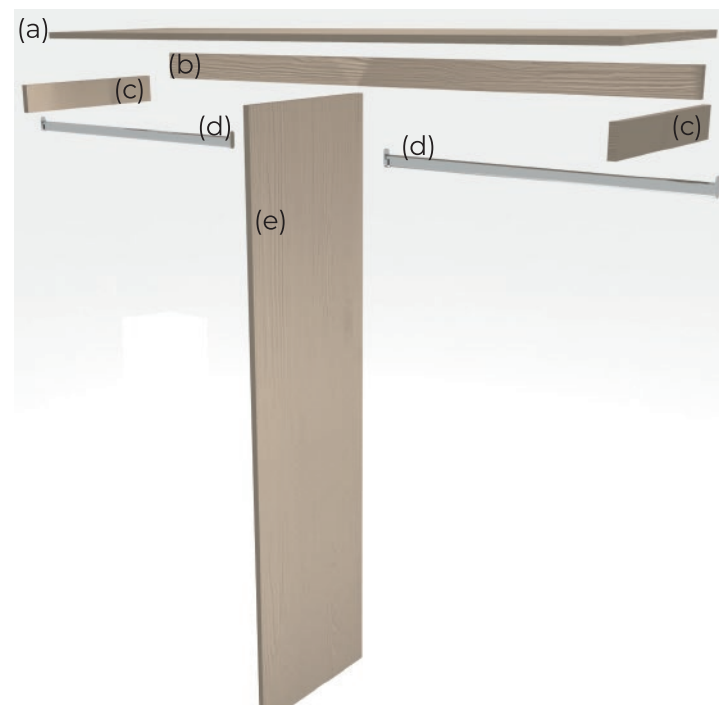

Internal Storage Components

- (a) - Shelf 1200mm / 2400mm
- (b) - Rear fillet
- (c) - Side fillet
- (d) - Chrome hanging rail
- (e) - Haffit / Stanchion Panel

What you need...



Tape Measure



Pencil

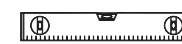

Spirit Level



Drill & Drill Bit



Suitable Fixings



Screwdriver



Fine-Tooth
Hacksaw

Important

1. Clear your working area from distractions before you commence work.
2. There are some small components involved in this assembly, ensure they are out of reach of children at all times.
3. For safe manual handling, it is recommended that 2 people carry out this assembly.
4. Ensure there are no cables or pipes where you will be drilling.

Read these instructions carefully before commencing with the installation.

End & Lid Panels

Location & Size (a)

Measure the length of the aperture, taking into account the length of track, number of doors and ideal overlap of the sliding doors and mark the end panel location.

Hold the panel in position and mark any cuts you are required to make, including the skirting board to ensure a flush finish to the wall.

Lid Installation (b)

The lid panel can be secured to the top of the end panels using modest blocks (c) or L-shaped brackets spaced at 500mm along the length of the panel.

Note: The lid panel can be identified as being edged on ends as well as the front.

Securing Panels

Panels should be secured to the wall using modesty blocks(c) or L-shaped brackets spaced length of the panel.

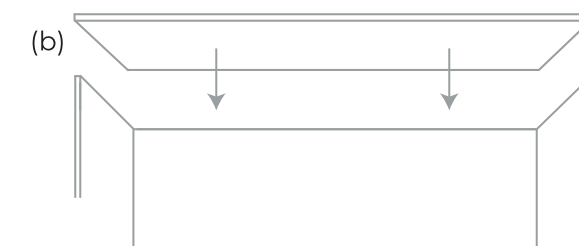
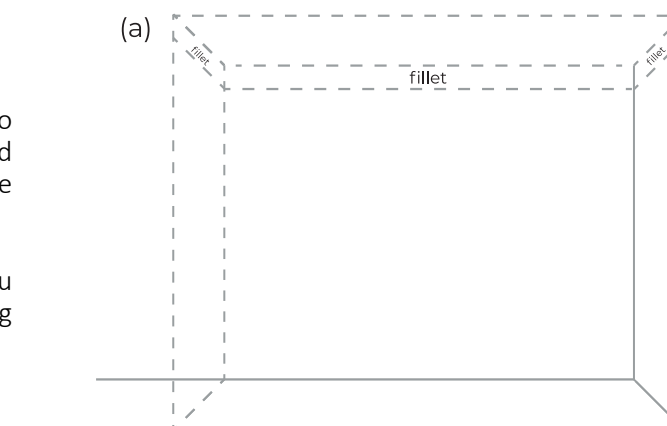
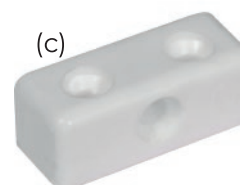

Wardrobe Door Installation

kelvin[®]
direct

What you need...



Tape Measure



Pencil

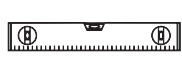

Spirit Level



Drill & Drill Bit



Suitable Fixings



Screwdriver



Fine-Tooth Hacksaw

Important

1. Clear your working area from distractions before you commence work.
2. There are some small components involved in this assembly, ensure they are out of reach of children at all times.
3. For safe manual handling, it is recommended that 2 people carry out this assembly.
4. Ensure there are no cables or pipes where you will be drilling.

Read these instructions carefully before commencing with the installation.

1 Tracks

Sizing the Tracks

Cut tracks to size using a fine-tooth hacksaw. Measure both the top and bottom of your opening for your track lengths.

Top Track

Position the track into the top of the opening.

Mark where holes need to be drilled in the track. We recommend fixings placed 100mm from each end and at regular intervals across the track.

Drill and plug the header/ceiling in line with the holes drilled in the track and fix the top track using the long screws provided.

Floor Track

Position the track on the floor of the opening. The floor track should be positioned 30mm behind the front of the top track.

Mark where holes need to be drilled in the track. We recommend fixings placed 100mm from each end and at regular intervals across the track.

Before permanently fitting the floor track to your floor, fit a door into place and adjust the track using a spirit level so the door becomes vertical.

Installing the Floor Track

When you are confident with the position of your floor track and after testing it to ensure the doors are vertical, remove the door and fix the bottom track to the floor using suitable fixings.

Note: We recommend fixing the floor track to a sole plate where carpet is installed.

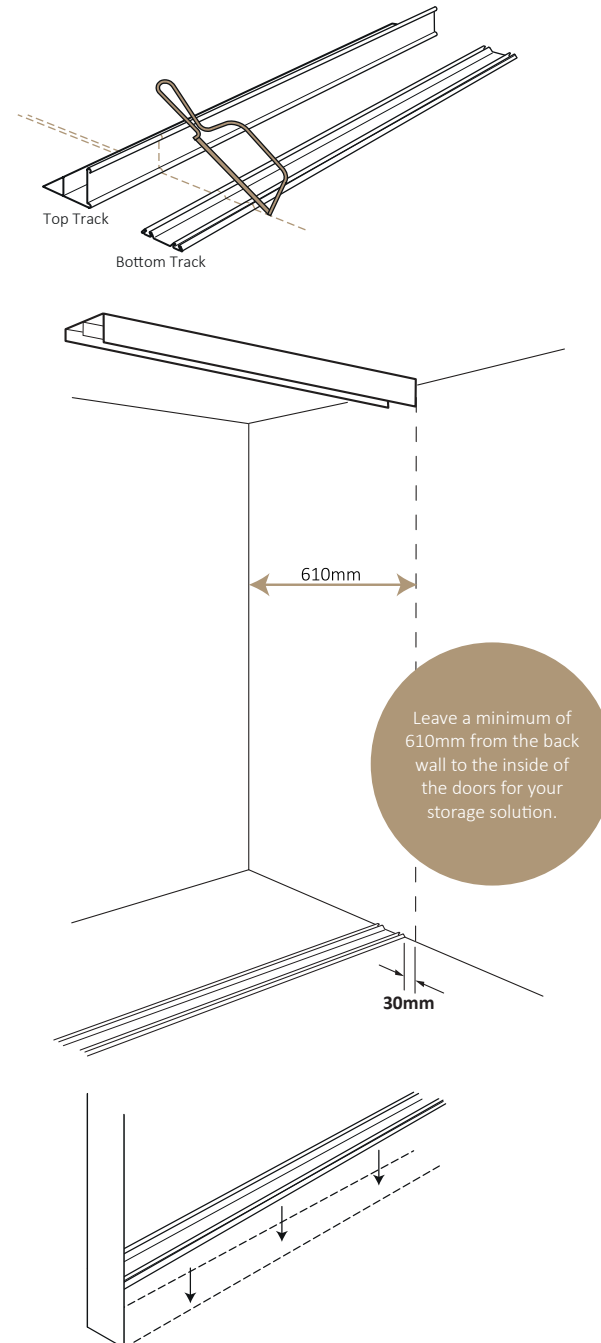

Products may vary. Illustrations are not to scale.

kelvin[®]
direct

2

Doors

Door Layout

Position your doors using the below diagram to allow for maximum opening areas and overlaps.

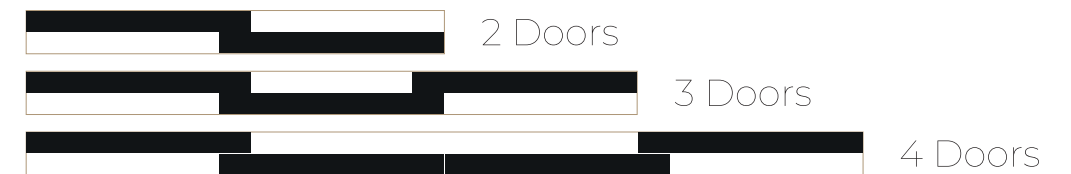

Installing the Doors

Back door(s) first, angle the door and insert it into the top track and lower the wheels into the floor track by straightening the door.

This should be done by two people to ensure safe manual handling.

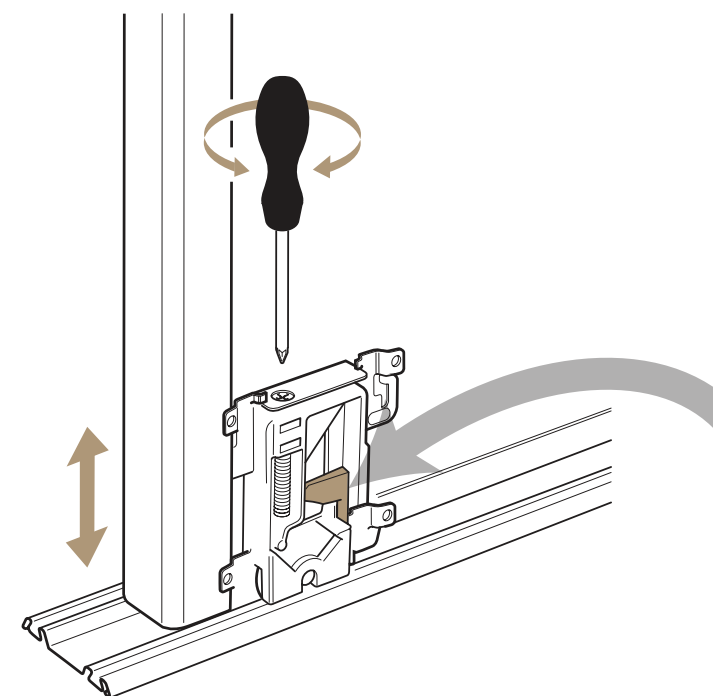
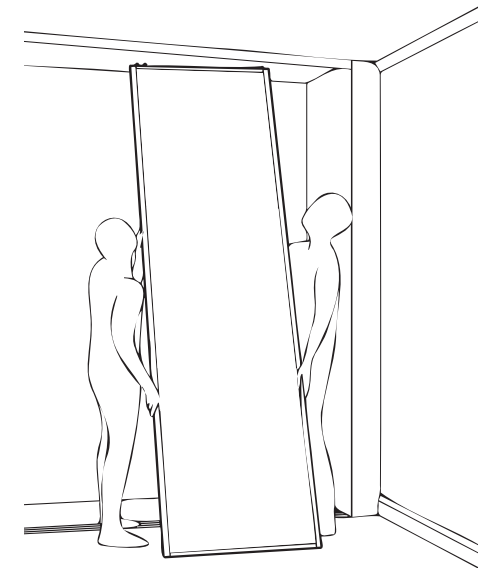

Adjusting the Doors

Align the doors with the side walls. Using a Pozidriv screwdriver, correct the door alignment by turning the screw found on the wheel guides. Turn the screw clockwise to lower the door and anti-clockwise to raise the door. Adjust both the left and right wheels as required.

Engage the anti-jump clip by...

- ➔ Rotating the clip open and out.
- ➔ Pushing the clip down.
- ➔ Rotating the clip in and closed.

Products may vary. Illustrations are not to scale.



Order online at
www.kelvindirect.co.uk
