

Erection of Caro WaterDoor (Face and Reveal)



The first (Bottom) panel is lowered into position, ensuring it is correctly positioned with the thicker Dual Hardness seal at the bottom of the panel.

NB. Bottom panels are determined by the fact that they have two seals – top and bottom

Then (if applicable) the second or third (Middle) panels are lowered onto the first (Bottom) panel, ensuring their lower section completely engages with the top of the panel below, completely covering the lower panels top seal.

NB. Middle panels are determined by the fact that they only have one Middle Seal (on the top)

It is important to check that both ends of the Middle Seal extend completely to either end of the panel. If they are short of the end there is a chance that they will not seal to the vertical D-Seal on the Fixed or demountable Post.

The last (Top) panel is lowered into position, also ensuring its bottom groove engages with the top of the middle panel.

NB. Top panels are determined by the fact that they have no seals.



Once all panels have been pushed down so that they fully engage with each other, the Compression Blocks can be inserted and their bolts can then be finger tightened – do not use any tools at this stage.

Push all panels towards the back of the wall post, onto the vertical D Seal and then, again by finger tightening only, ensure all the panels are firmly pushed against the vertical D Seal.

Now, using the T-Bar tool supplied, apply two full turns to the vertical compression screws.

Now, starting from the bottom panel upwards, give the horizontal compression screws one full turn, the left and then the right, working up to the top.

Do not over tighten.

Once this is completed your WaterDoor barrier will be ready to protect you and your property.



CARO Flood Defence Systems

Installation and Erection Instructions for Caro WaterDoor

Edge Barn, 11 Market Hill, ROYSTON Herts SG8 9JN
Tel: 00 44 (0) 1763 244446 Fax: 00 44 (0) 1763 244111
Email: info@caro.co.uk Web: www.caro.co.uk

Installation of Wall Rails (Face and Reveal)



Clean walls and base with brush and ensure that there are no raised obstructions or projections that could affect the final position of the Wall Post

Confirm previously made measurements of opening widths



Using CT1 Adhesive Sealant (available from your local Merchant or CaroFDS directly) apply in two continuous lines down the full length of Wall Post back

SUGGESTION – prior to the application of the CT1 use some masking tape along the sides that will have CT1 applied to seal the edges. This will allow excess CT1 to be kept away from sides and threaded holes and give a neat tidy finish to the finally applied areas

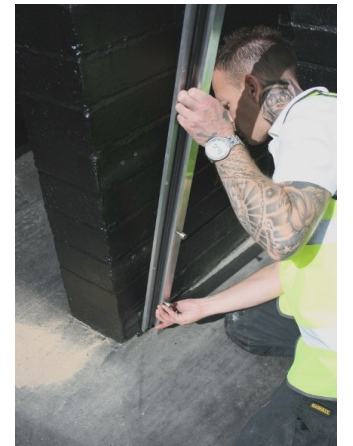

If top and bottom gaps vary, take the smallest size. You must ensure that finished rails are totally vertical

Place EPDM Rubber Wall Post Sealing Pad in position so that Wall Post will compress and seal to the pad when fixed

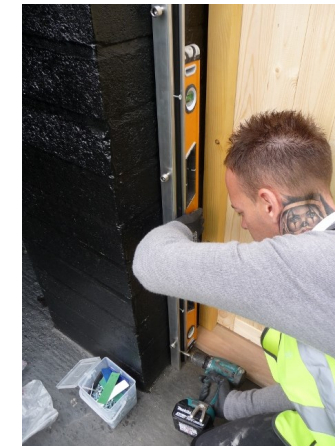

Hold the post in position, with back against wall, so fixing screws can be inserted into top and bottom holes

Using spirit level and packing shims, tighten all screws and ensure that finished Wall Post is completely vertical

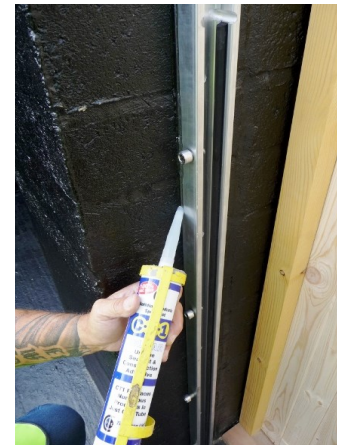

NOTE: The Vertical D-Seal is supplied so that it 's position is retained, so that it is longer than the Wall Post. This is to ensure that when the Wall Post is positioned onto the EPDM Pad the D-Seal will also seal into the Pad

Use packing shims (normally for double glazing) easily available from Builders Merchants - so if narrow at bottom, pack out at top – if narrow at top pack out at bottom

Mark hole positions – drill holes and insert plugs to suit 6 x 50 screws ensuring that the Wall Post is compressing the EDPM Pad



Apply extra CT1 to all exposed edges to completely seal the verticals and finish the aesthetic look of the installation

Trim off excess edges of EPDM Pad under wall post and, if required, apply CT1 sealant adhesive in cases of "rough" ground, without obstructing inner opening.

